

TILLAMOOK COUNTY SURVEYORS OFFICE
COURTHOUSE, TILLAMOOK, OREGON 97141

SECTION CORNER COMMON TO SECTIONS 15 AND 22, TOWNSHIP 2 SOUTH,
RANGE 9 WEST, WILLAMETTE MERIDIAN, TILLAMOOK COUNTY, OREGON.

I FOUND A 3" DIAMETER OREGON STATE BOARD OF FORESTRY BRASS DISK
ENCASED IN A 10" DIAMETER TILE WITH CONCRETE. THE MONUMENT WAS
FOUND IN GOOD CONDITION AND STAMPED AS SHOWN HEREON. I PLACED A 12"
PLASTIC CYLINDER AROUND THE EXISTING MONUMENT AND CONCRETE AND I
THEN PLACED 180 POUNDS OF CONCRETE IN THE CYLINDER AND AROUND THE
EXISTING MONUMENT.

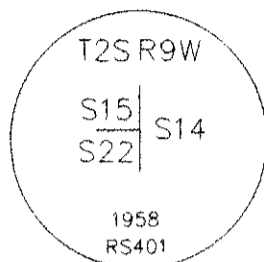

HISTORY OF FOUND MONUMENT

SAMUEL D. SNOWDEN, GLO SURVEYOR, SET A POST AND BEARING TREES AT
THE CORNER OF SECTIONS 14, 15, 22 AND 23 IN 1857. HENRY MELDRUM, GLO
SURVEYOR, WHILE RESURVEYING A PORTION OF TOWNSHIP 2 SOUTH RANGE 9
WEST IN 1884, VISITED THE CORNER TO SECTIONS 15 AND 22. ACCORDING TO
REWITNESS BOOK 1, PAGE 320 THIS CORNER WAS RESTORED BY W.E.
ANDERSON IN 1925 AND RECORDED IN FIELD BOOK P1, PAGES 122-124 AND 128.
THE CORNER WAS THEN RESTORED BY THE OREGON STATE BOARD OF
FORESTRY ON APRIL 4, 1958 BY RICHARD A. MORRIS. THE CORNER WAS THEN
REWITNESSED BY THE TILLAMOOK COUNTY SURVEYORS OFFICE ON APRIL 23,
1980 BY REWITNESS BIN NUMBER 395.

IN FEBRUARY OF 2006, THE MONUMENT WAS FOUND AS DESCRIBED ON
REWITNESS BIN NUMBER 395, AND THE ACCESSORIES FOUND AND/OR SET AT
THAT TIME TO NOW BE AS FOLLOWS:

REWITNESS BIN NUMBER 395 – FOUND HEMLOCK STUMP, SCRIBING VISIBLE (46"
DIAMETER HEMLOCK TREE SOUTH 62° WEST 70.4'); 02-09-06 – FOUND A 6' TALL
HEMLOCK STUMP WITH VISIBLE SCRIBING AT RECORD POSITION.

REWITNESS BIN NUMBER 395 - FOUND HEMLOCK STUMP, SCRIBING VISIBLE (38"
DIAMETER HEMLOCK TREE NORTH 12-1/2° WEST 73.7'); 02-09-06 – FOUND A 5'
TALL HEMLOCK STUMP WITH ROTTED FACE AND NO VISIBLE SCRIBING AT
RECORD POSITION.

REWITNESS BIN NUMBER 395 – A 4" DIAMETER FIR TREE SCRIBED "S15 BT"
NORTH 22° WEST 4.80'; 02-09-06 -FOUND A 6" DIAMETER FIR TREE WITH A
HEALED FACE AT RECORD POSITION.

REWITNESS BIN NUMBER 395 – A 5" DIAMETER HEMLOCK TREE SCRIBED "S22
BT" NORTH 22° WEST 4.80'; 02-09-06 - *FOUND A 24" DIAMETER HEMLOCK TREE
WITH A HEALED FACE AT RECORD POSITION.

REWITNESS BIN NUMBER 395 – FOUND A 4" X 4" X 72" WCPC 1.5' N.E.; (SET A 4" X
4" X 72" WHITE PAINTED CEDAR POST 1.5' NE OF PIPE); 02-09-06 – GONE.

REWITNESS BIN NUMBER 395 – SET AN 84" HAT SECTION POST WEST 1.5 FEET;
02-09-06 – FOUND IN GOOD CONDITION AND AT RECORD POSITION.

REWITNESS BIN NUMBER 395 – FOUND OREGON STATE BOARD OF FORESTRY
YELLOW METAL LOCATION TAG ON A 31" DIAMETER HEMLOCK STUMP SOUTH
14° WEST 7.2' WITH A TRIANGLE CHOPPED IN STUMP; (SET AN OREGON STATE
BOARD OF FORESTRY METAL LOCATION POSTER ON 31" HEMLOCK, S14W 7.2');
02-09-06 – FOUND HEMLOCK STUMP AT RECORD POSITION , METAL TAG GONE.

() INDICATES RECORD VALUE FROM REWITNESS BOOK 1, PAGE 320.

* INDICATES NEW TILLAMOOK COUNTY YELLOW METAL LOCATION POSTER
TAG ATTACHED.

SURVEYS AND REWITNESSES OF RECORD

G.L.O. Contract #67 by Samuel D. Snowden in 1857, BLM Volume: OR-R0053 Page: 0333.0
G.L.O. Contract #500 by Henry Meldrum in 1884, BLM Volume: OR-R0309 Page: 0958.0
BOOK 2S9, PAGES 4-1/2 & 47, Tillamook County Survey Records.
REWITNESS BOOK 1, PAGE 320, April 1958, Tillamook County Survey Records.
Field Book P-1 Pages 121-124 and 128, June 1925, Tillamook County Survey Records.
REWITNESS BIN NUMBER 395, April 1980, Tillamook County Survey Records.
MAP B-404, Richard A. Morris, L.S. 401, March 1959, Tillamook County Survey Records.
MAP A-965, Richard A. Morris, L.S. 401, Oct. 1961, Tillamook County Survey Records.
MAP A-1209, Richard A. Morris, L.S. 401, Nov. 1964, Tillamook County Survey Records.
MAP B-1225, Allan E. Duncan, L.S. 793, Dec. 1985, Tillamook County Survey Records.

GEODETIC POSITION OF MONUMENT

LATITUDE = 45° 23' 25.01754" NORTH; LONGITUDE = 123° 45' 46.44496" WEST
DATUM IS NAD '83 – '91

LOCATION OF MONUMENT

THIS SECTION CORNER IS LOCATED APPROXIMATELY 25 FEET SOUTH OF A
GRAVEL LOGGING ROAD AND APPROXIMATELY 125 FEET EAST OF AN
INTERSECTION OF FOUR ROADS.

IN THE PRESENCE OF, AND REWITNESSED BY DANNY R. MCNUTT, TILLAMOOK
COUNTY SURVEYOR, JOE JENSEN, SURVEY SUPERVISOR , AND AL DVORAK,
SURVEY TECHNICIAN, TILLAMOOK COUNTY SURVEYOR'S OFFICE.

February 09, 2006

TITLE:

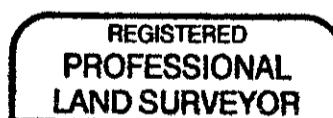
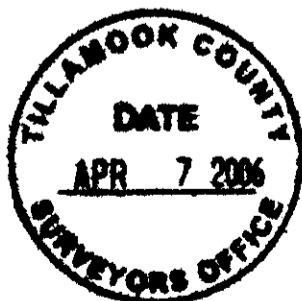

Danny R McNutt C.S.

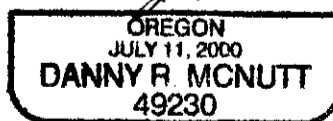

RENEWAL12 - 31-